

Rohs Compliance

电容印字图案:

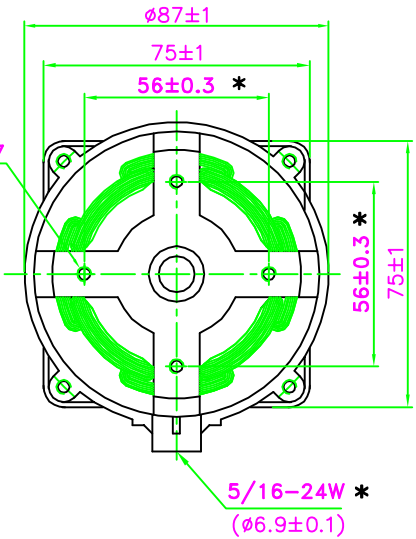

10. PERFORMANCE (ON LOAD) (16寸新能效风叶):
 HIGH=(0.20A 445Ω 1200RPM)±10% 45W±5%
 MED=(0.19A 535Ω 1050RPM)±10% 42W±5%
 LOW=(0.18A 585Ω 900RPM)±10% 40W±5%
11. START VOLTAGE (With Fan) (带风叶低速启动): ≤132V;
 12. Strength of gear box (牙箱L杆扭力): 5N-8KG;
 13. Temp Rise ≤75K ;

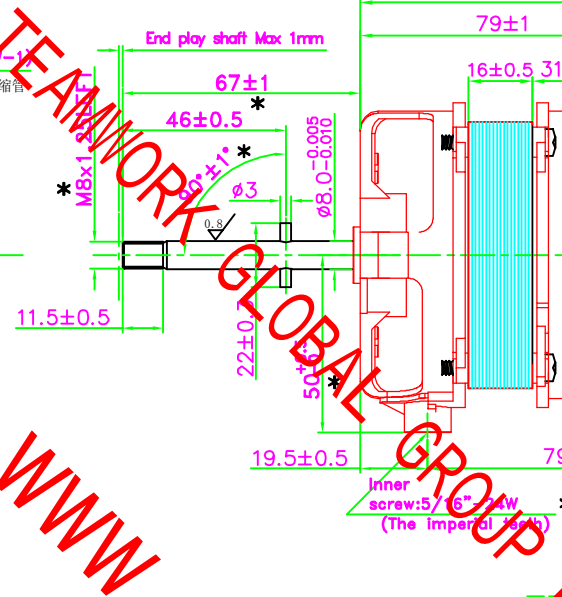
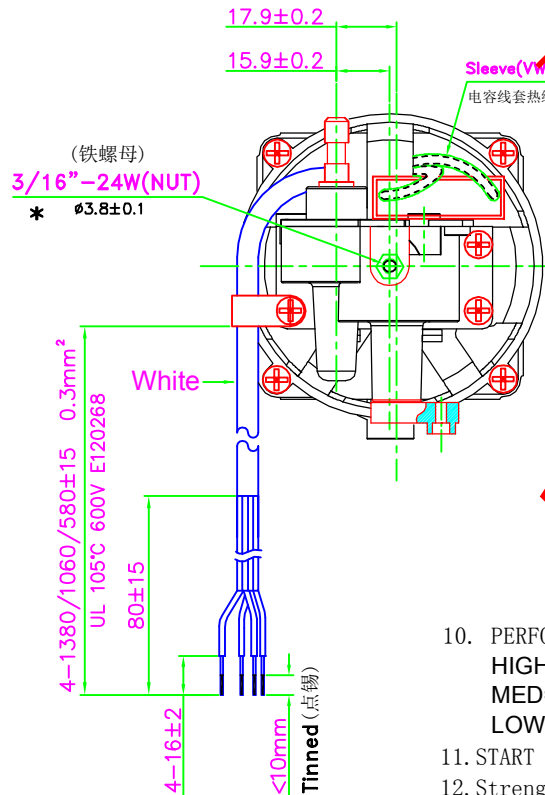
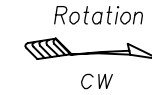
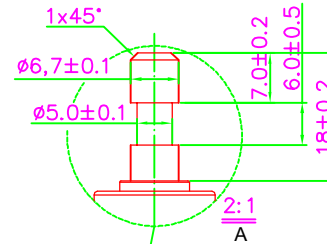
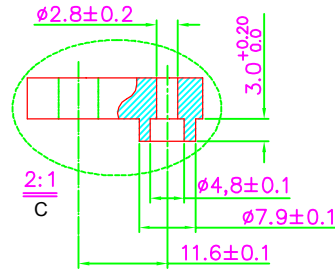
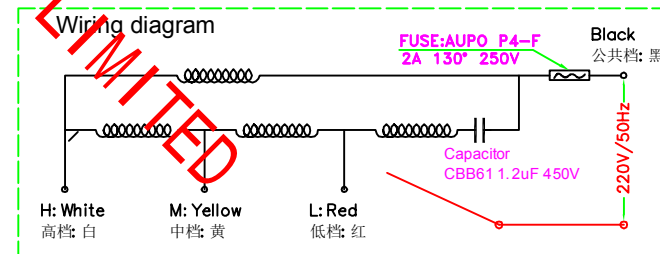

GENERAL TOLERANCES ISO 2768-m	
Permissible deviations for linear dimensions	
Permissible deviations for basic size range	
>0.5	>0.5
..3	..8
..3	..8
..30	..120
..400	..1000
..2000	..4000
m	±0.1
±0.1	±0.2
±0.2	±0.5
±0.5	±1.2
±2	±2
Permissible deviations for angular dimensions	
Permissible deviations for bevel angles (external radii/shank heights)	
..10	>10
..50	>50
..120	>120
..400	>400
..0.5	>0.5
..3	>3
..8	..8
m	±1'
±1'	±2'
±2'	±5'
±5'	±1'

REMARK:

- KIND OF MOTOR: SINGLE-PHASE ASYNCHRONOUS MOTOR WITH PERMANENT (4POLES);
- DIRECTION OF ROTATION: CLOCK WISE (FROM SHAFT END);
- SOURCE: SINGLE PHASE 220V/50Hz;
- FUSE: AUPO 130° C/2A/250V;
- CAPACITOR: 1.2uF ±5% /450V;
- STATOR: 75*φ44.5*16mm, ROTOR: 16mm;
- LEADER WIRE: UL 1015 22AWG 105°C *580/1060/1380mm;
- PARAMETER: MAIN COIL: φ0.15*810T, AUX. COIL: φ0.13*(595T+180T+130T);
- CLASS OF INSULATION: CLASS B;

REV	DESCRIPTION	DATE	BY
DWG. BY: GYZ	CHK. BY	APP. BY ADWARD	
Date (yy/mm/dd): 2018-01-31	Date (yy/mm/dd)	Date (yy/mm/dd) 2018-01-31	
MATERIAL	SCALE 3:1		
FINISH:	NOT SCALE		
General Tolerance ISO 2768-m Class m Unless specified		TITLE	
ALL DIMENSIONS ARE IN MILLIMETER		OD-7516M22 (New energy standard)	
SHENZHEN ODIN IMPORT AND EXPORT CO., LTD		DWG NO.	SHEET 1 OF 1
		7516M22 (New energy standard)	

SHENZHEN ODIN IMPORT AND EXPORT CO., LTD

Technical Datas

Motor Mode:OD-7516M22
(New energy standard)

Number Code:7516M22
(New energy standard)

ITEM	DESCRIPTION	STANDARD	MEASURING EQUIPMENT	AQL	
1	Testing Voltage	220V/50Hz	Voltmeter	AQL1.C	
2	Stator Lamination Stack Height	16(+0.3, -0.2) mm	Cauper	AQL4.C	
3	Distance Between End of Brackets	79±1 mm	Cauper	AQL4.C	
4	Shaft Extension Length	67(+1.5/-1.0) mm	Cauper	AQL4.C	
5	End Play	1mm MAX	Cauper	AQL4.C	
6	Direction Of Rotation	△ C.W	View	AQL4.C	
7	Fuse	△ AUPO F1-2A 130°C/2A/250V	View	AQL1.C	
8	Load Fan	16"	View	AQL4.0	
9	Hi-Pot Test	1500VAC/5mA/60sec	Hi-pot Tester	AQL1.C	
10	Strength Of Gear Box (牙箱L杆扭力)	5KG-8KG	Torsional Dynamometer	AQL4.C	
11	Vibration	11.2 mm/s	Vibration Tester	AQL4.C	
12	Noise Level	≤85dB(A) at 1m working in unit	Noise Meter	AQL4.C	
13	Lead Wire	△ VW-1 105° 600V E120268 580/1060/1380±15	Ruler	AQL4.C	
14	On Load Performance	H-Speed (RPM)	1200±10%	Stroboscope	AQL4.C
		H-Power (W)	45±5%	Wattmeter	AQL4.C
		M-Speed (RPM)	1050±10%	Stroboscope	AQL4.C
		M-Power (W)	42±5%	Wattmeter	AQL4.C
		L-Speed (RPM)	900±10%	Stroboscope	AQL4.C
		L-Power (W)	40±5%	Wattmeter	AQL4.C

Remark: The Item Noted With "△" Is Special And Important
Outline Drawing: OD-7516M22 (New energy standard)

Issued:GYZ 2018-01-31

Checked:Allen Lee

Approved:Adward 2018-01-31

